

Esperia_69

ESCALA 1:1

1

- (I) Sezione verticale traverso inferiore
- (F) Section verticale traverse inferieure
- (E) Seccion vertical travesañõ inferior
- (UK) Vertical section lower ledger

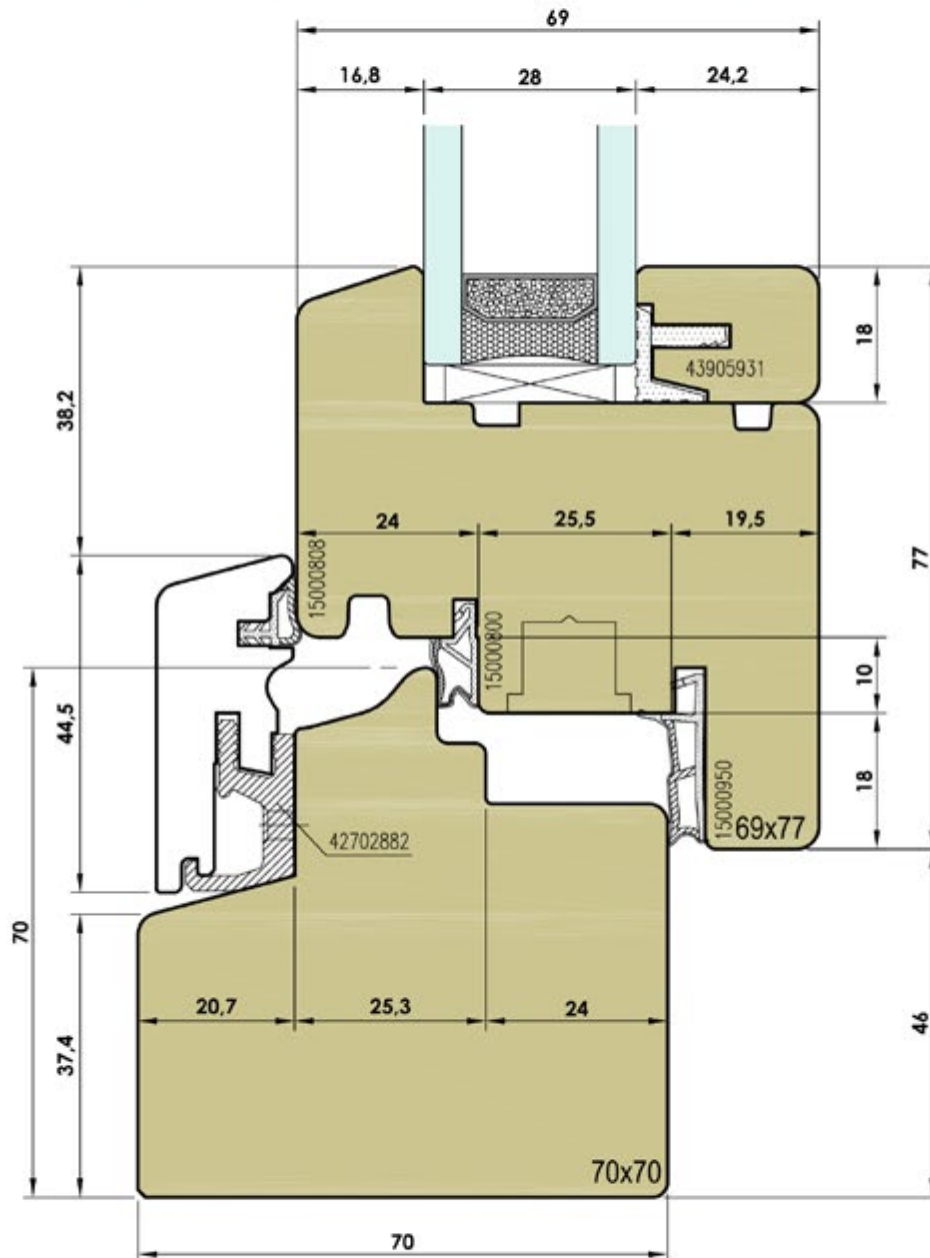
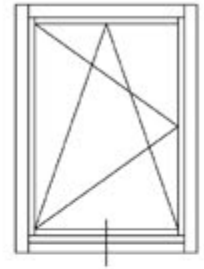
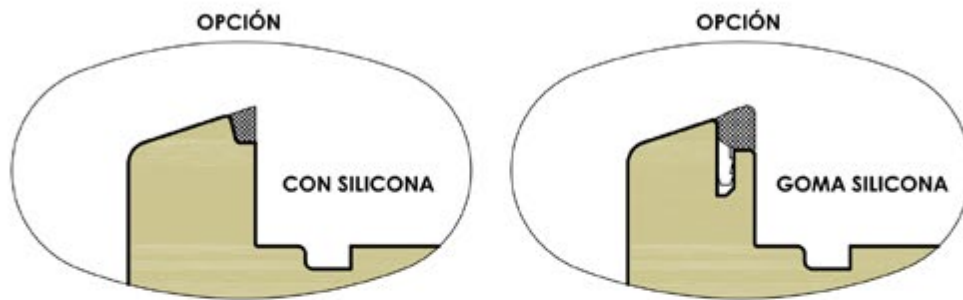

Esperia_69

ESCALA 1:1

- (I) Sezione verticale traverso inferiore
- (F) Section verticale traverse inferieure
- (E) Seccion vertical travesañõ inferior
- (UK) Vertical section lower ledger

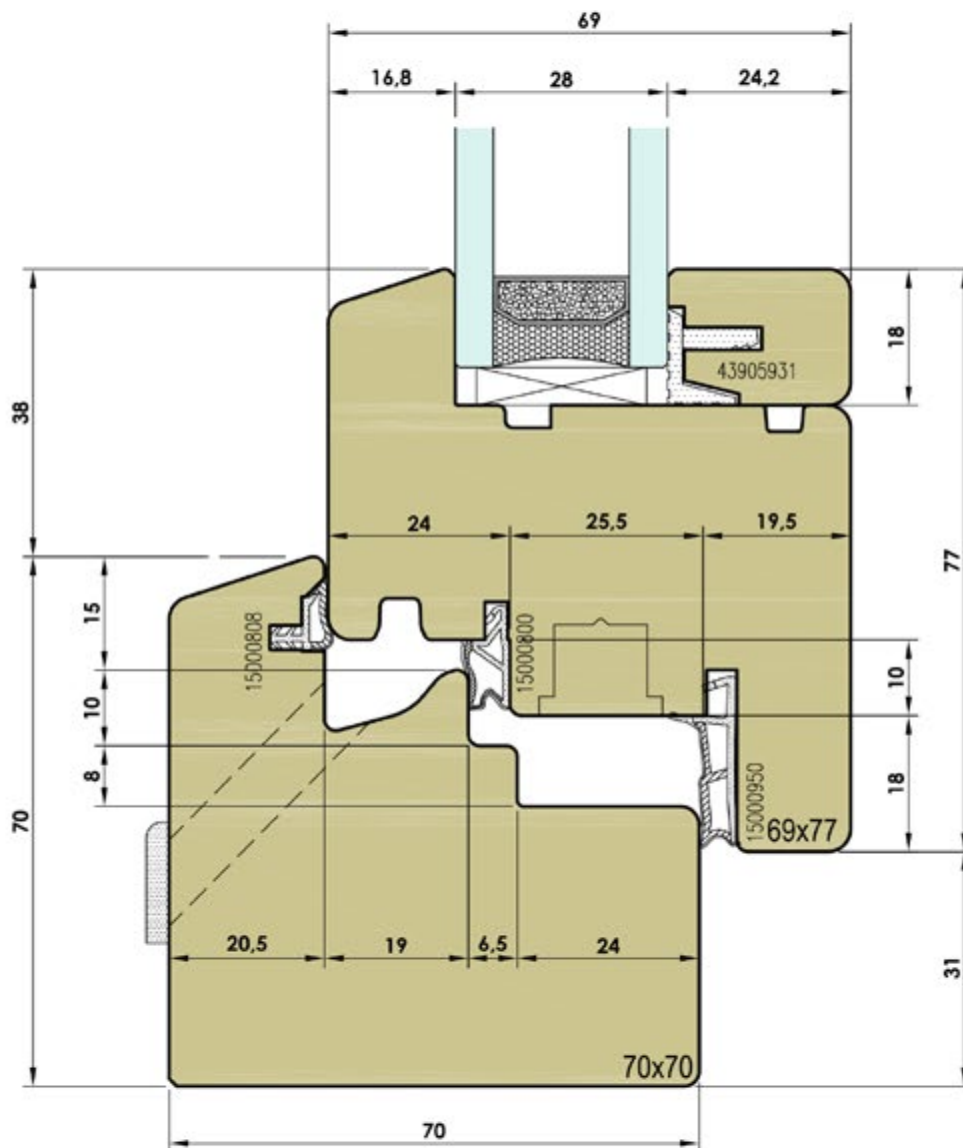
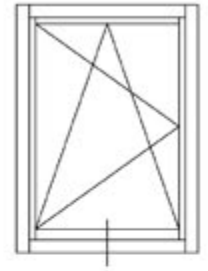
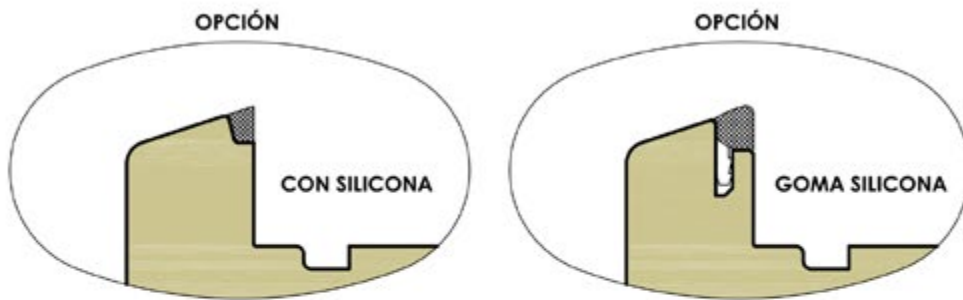

Esperia_69

ESCALA 1:1

- (I) Sezione verticale traverso inferiore
- (F) Section verticale traverse inferieure
- (E) Seccion vertical travesañõ inferior
- (UK) Vertical section lower ledger

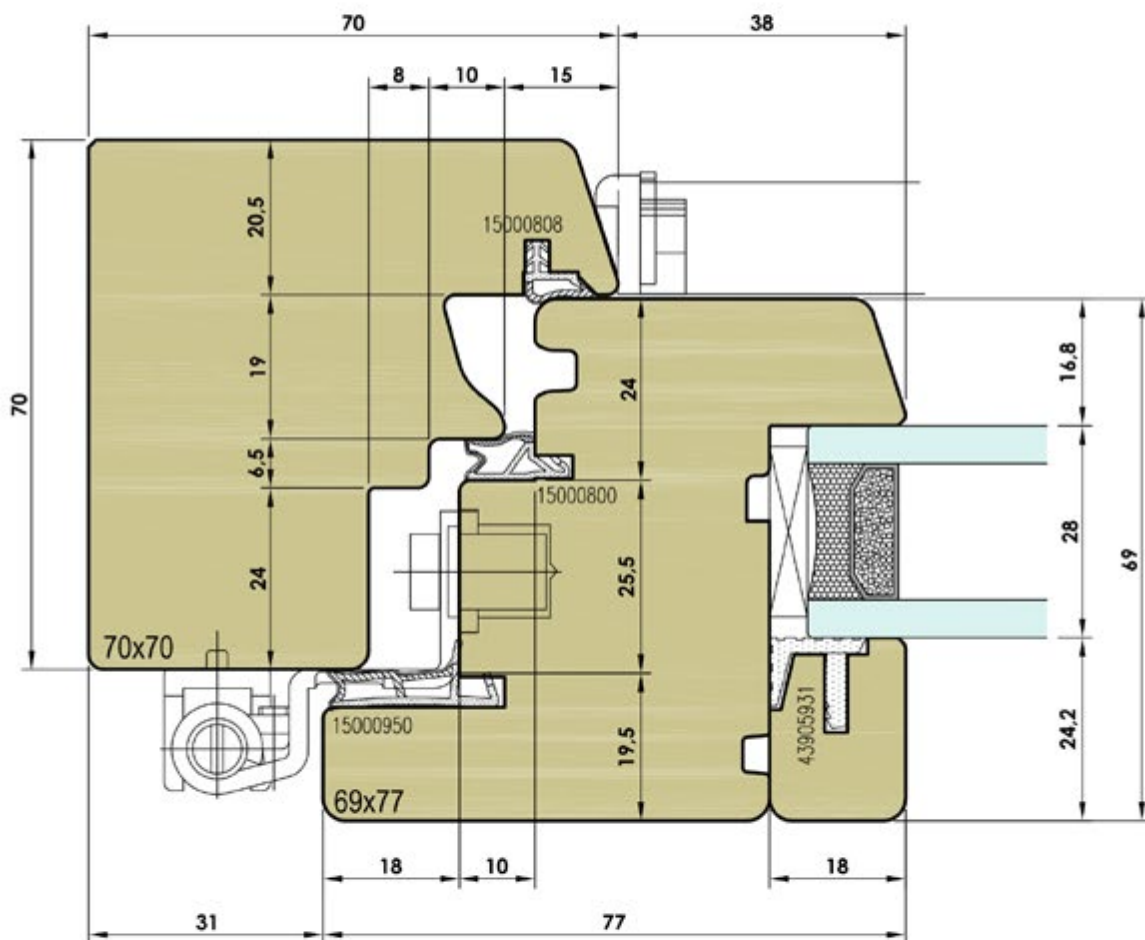
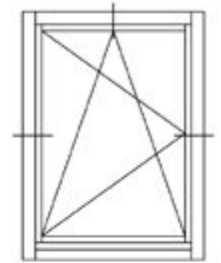

Esperia_69

ESCALA 1:1

- Ⓛ Sezione orizzontale montante
- Ⓧ Section horizontale montant
- Ⓧ Seccion horizontal montante
- Ⓧ Horizontal section of the jamb

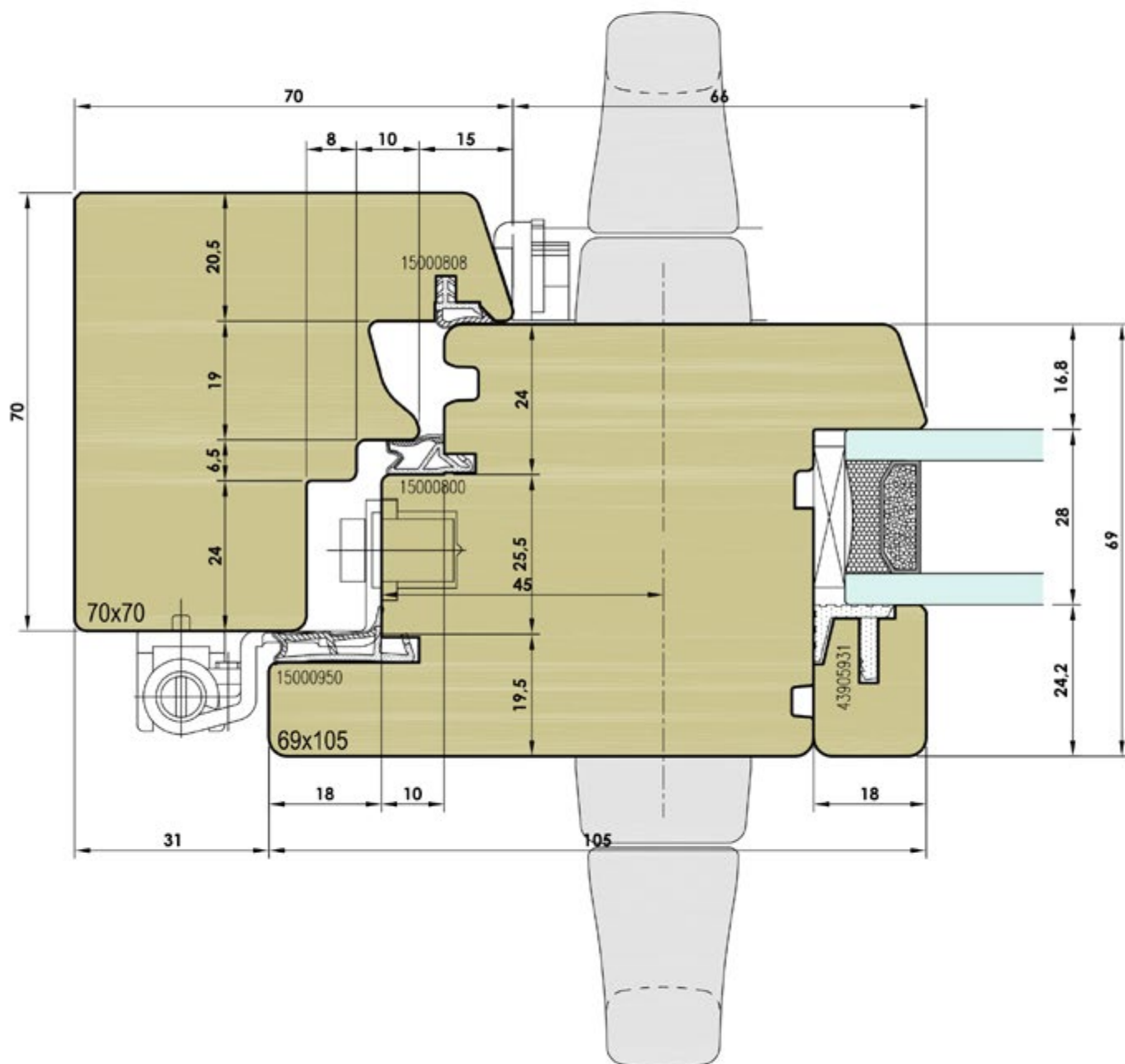
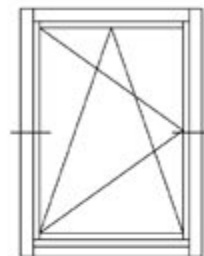

Esperia_69

ESCALA 1:1

5

- I Sezione orizzontale montante
- F Section horizontale montant
- E Seccion horizontal montante
- UK Horizontal section of the jamb

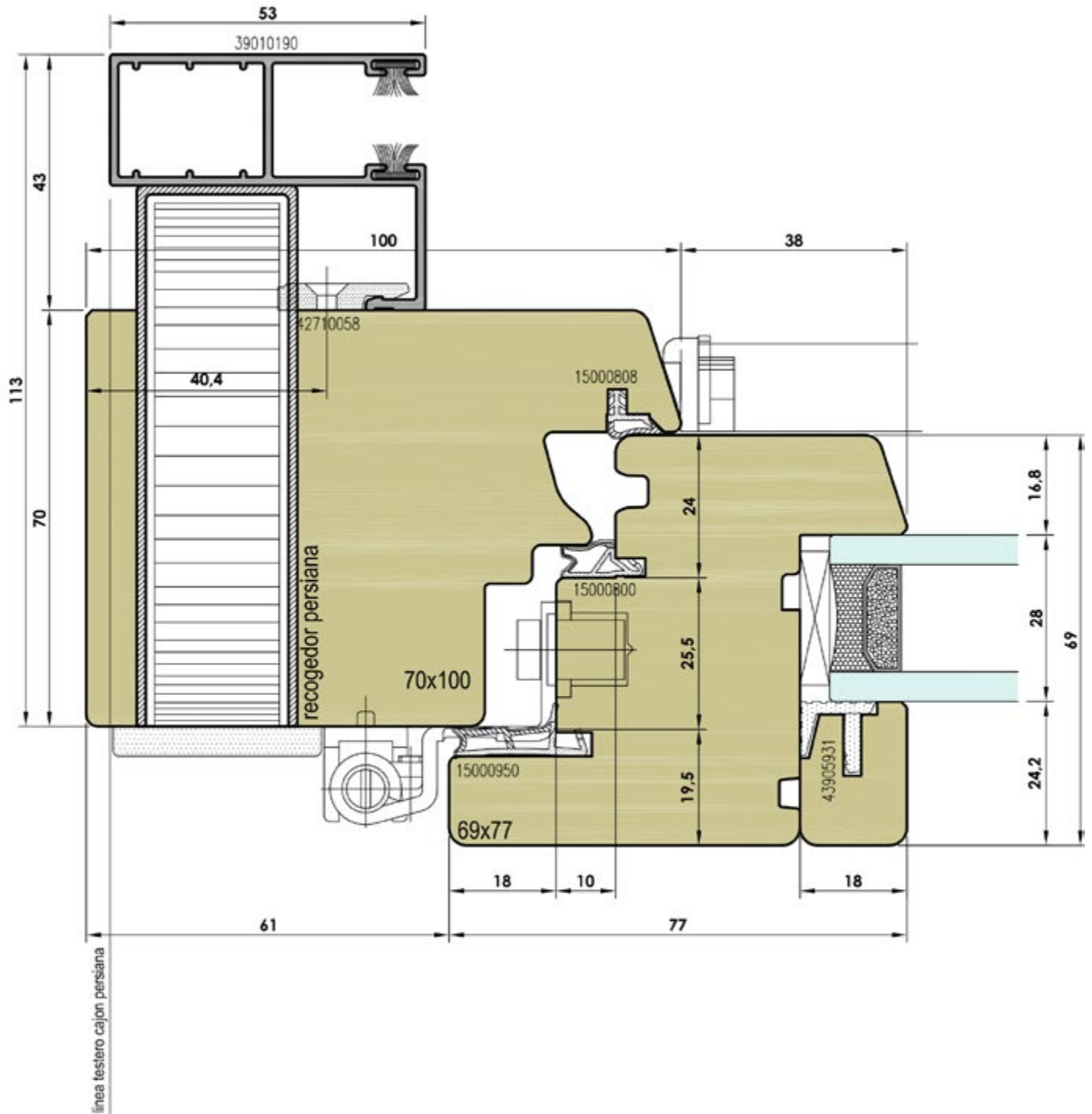
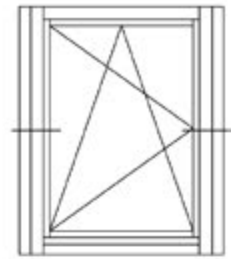

Esperia_69

ESCALA 1:1

6

- (I) Sezione orizzontale montante
- (F) Section horizontale montant
- (E) Seccion horizontal montante
- (UK) Horizontal section of the jamb

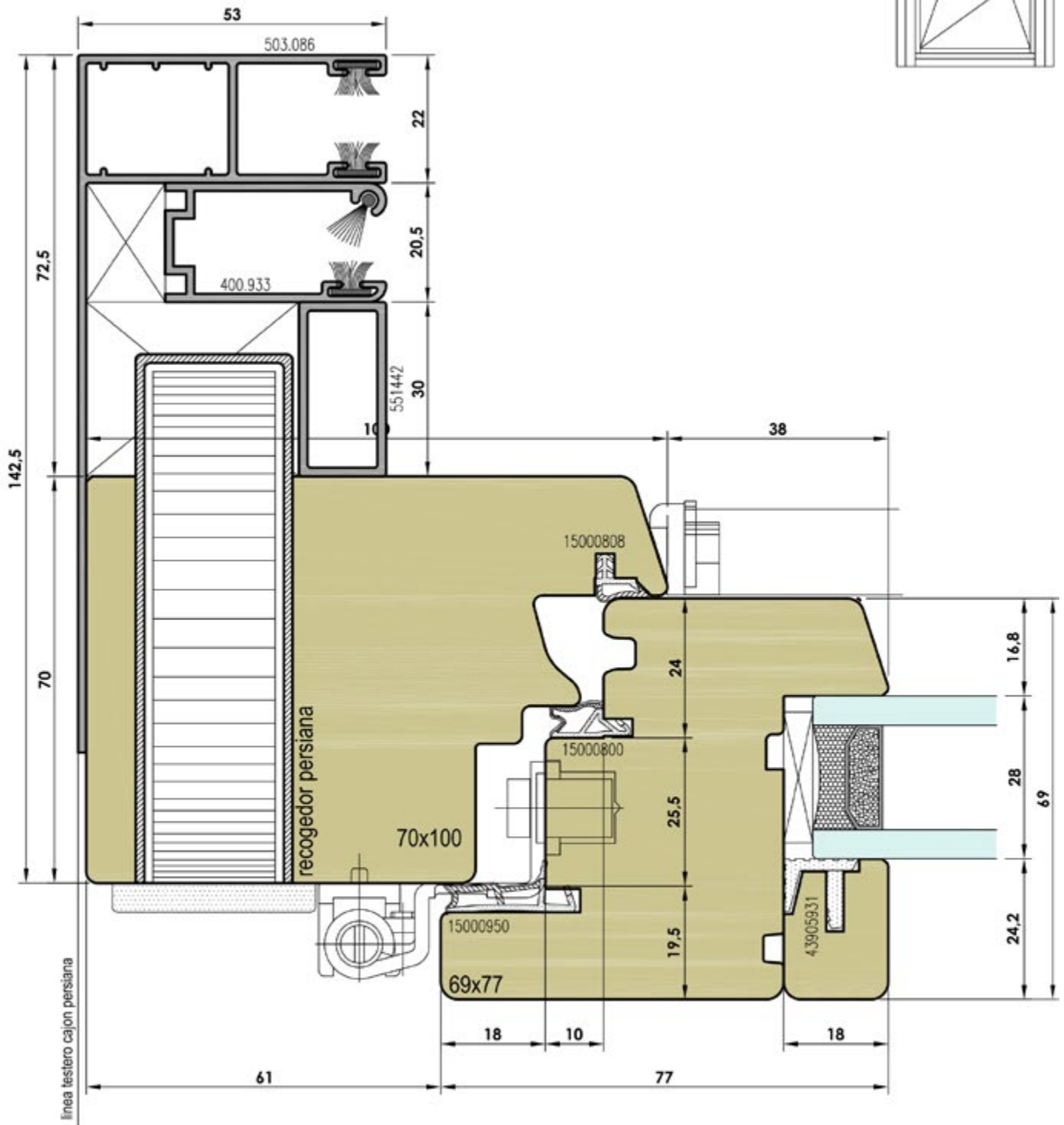
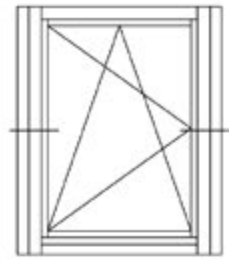

Esperia_69

ESCALA 1:1

7

- Ⓛ Sezione orizzontale montante
- ⓕ Section horizontale montant
- ⓔ Seccion horizontal montante
- ⓊⓀ Horizontal section of the jamb

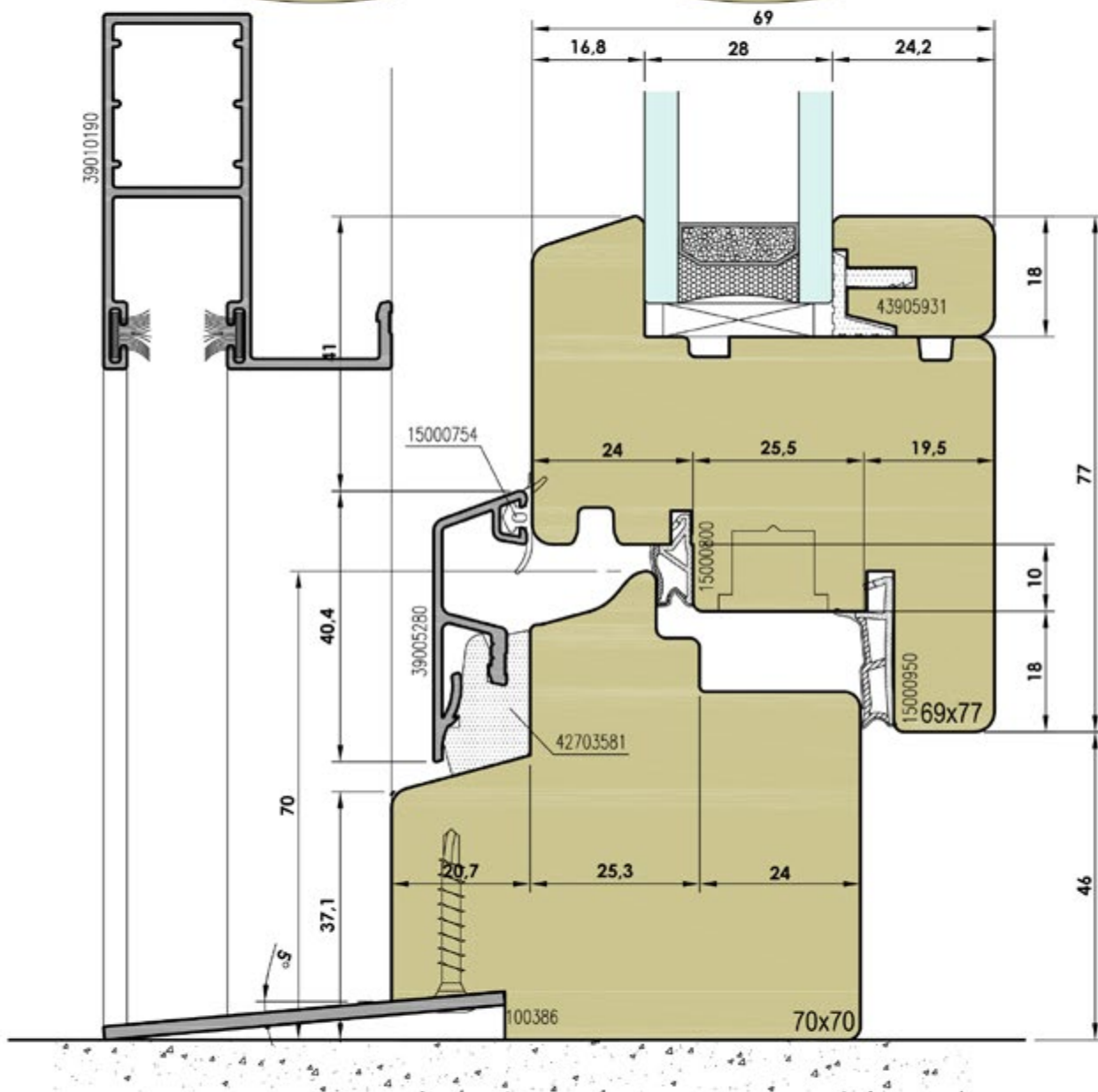
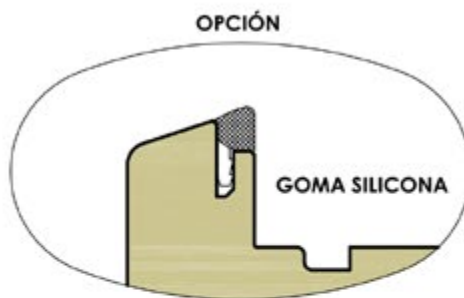
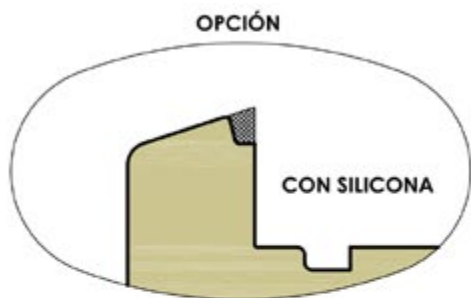
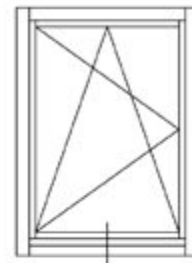

Esperia_69

ESCALA 1:1

- (I) Sezione verticale traverso inferiore
- (F) Section verticale traverse inferieure
- (E) Seccion vertical travesañõ inferior
- (UK) Vertical section lower ledge

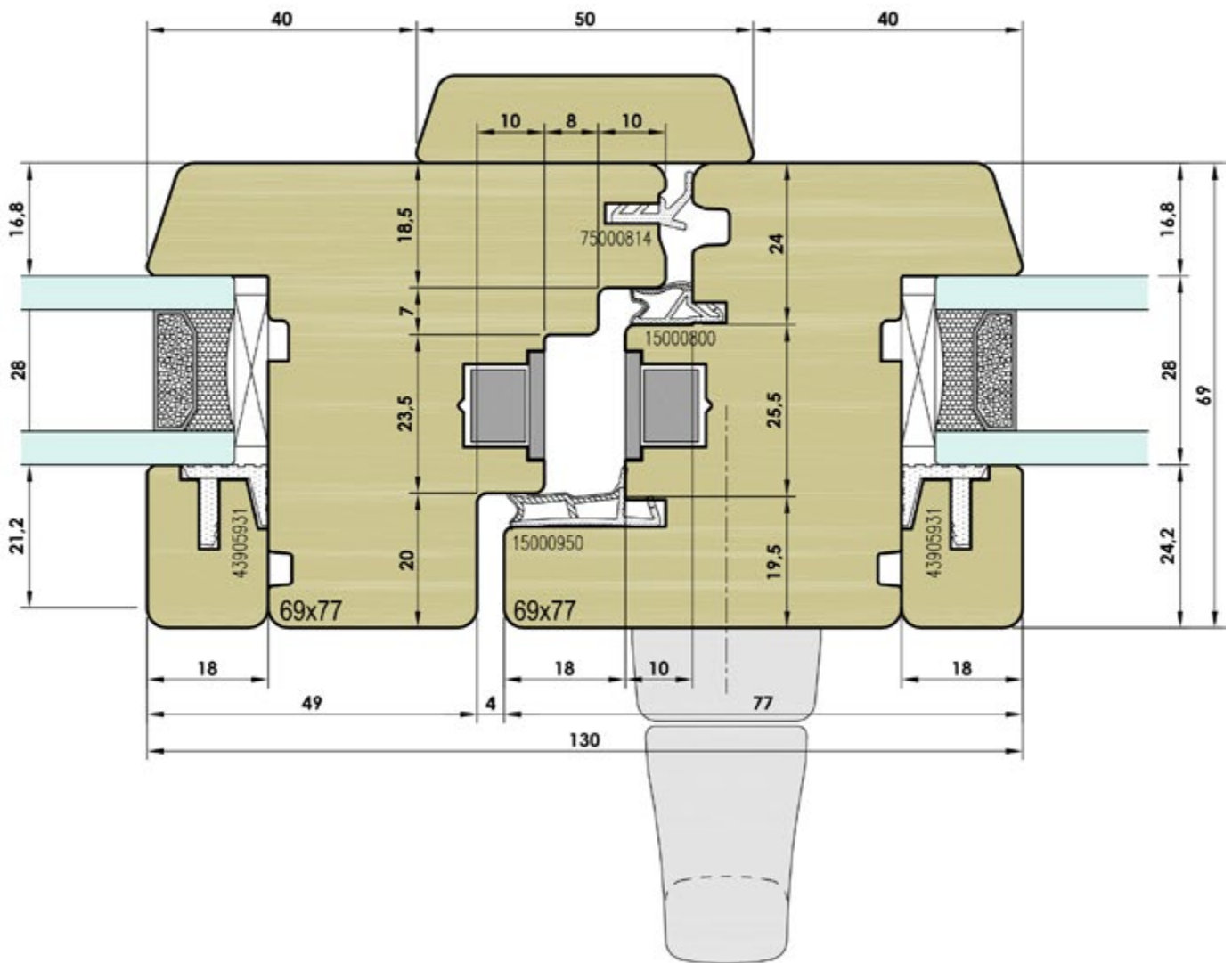
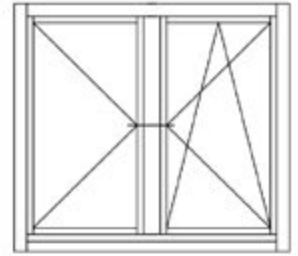

Esperia_69

ESCALA 1:1

- (I) Sezione orizzontale snodo centrale
- (F) Section horizontale montant centrale
- (E) Seccion horizontal cierre central
- (UK) Horizontal section of the middle clamp

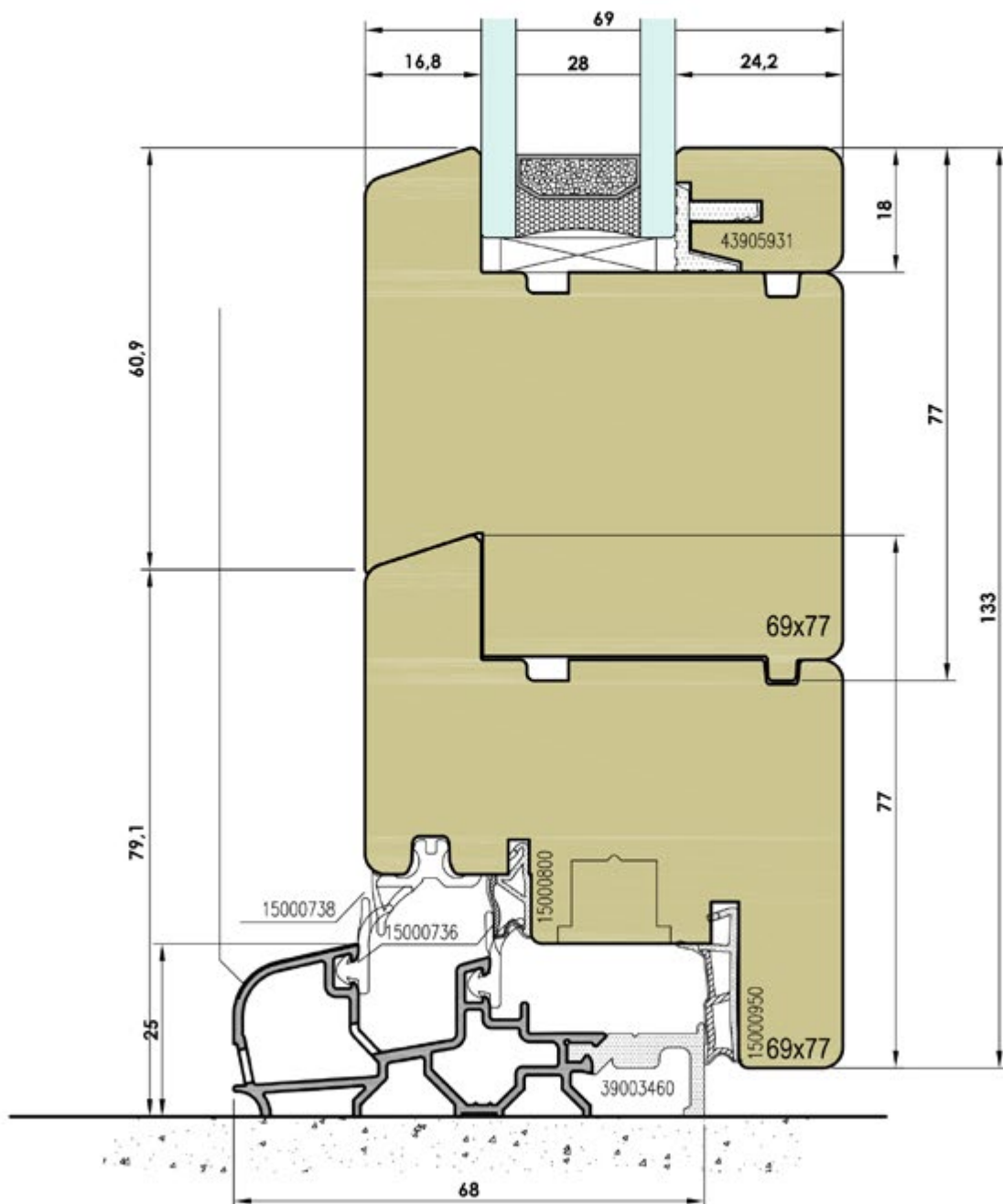
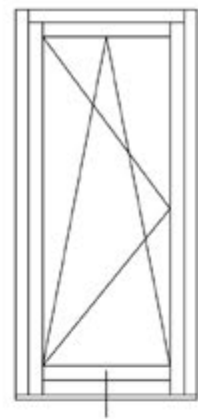
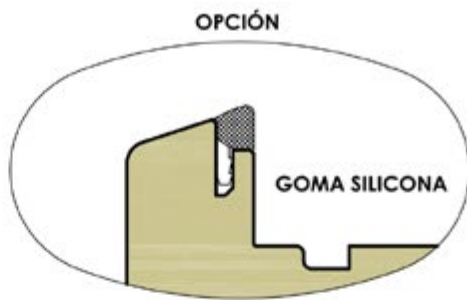
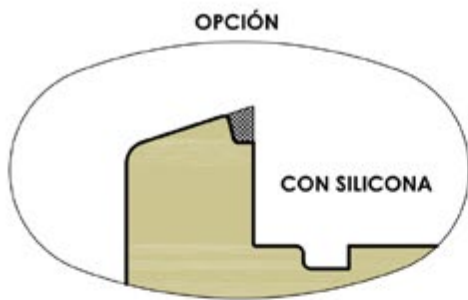

Esperia_69

ESCALA 1:1

- (I) Sezione verticale traverso inferiore con soglia
- (F) Section verticale traverse inferieure avec empilées sur seuil
- (E) Seccion vertical travesaño inferior con umbral
- (UK) Vertical section window-door aluminium lower ledger

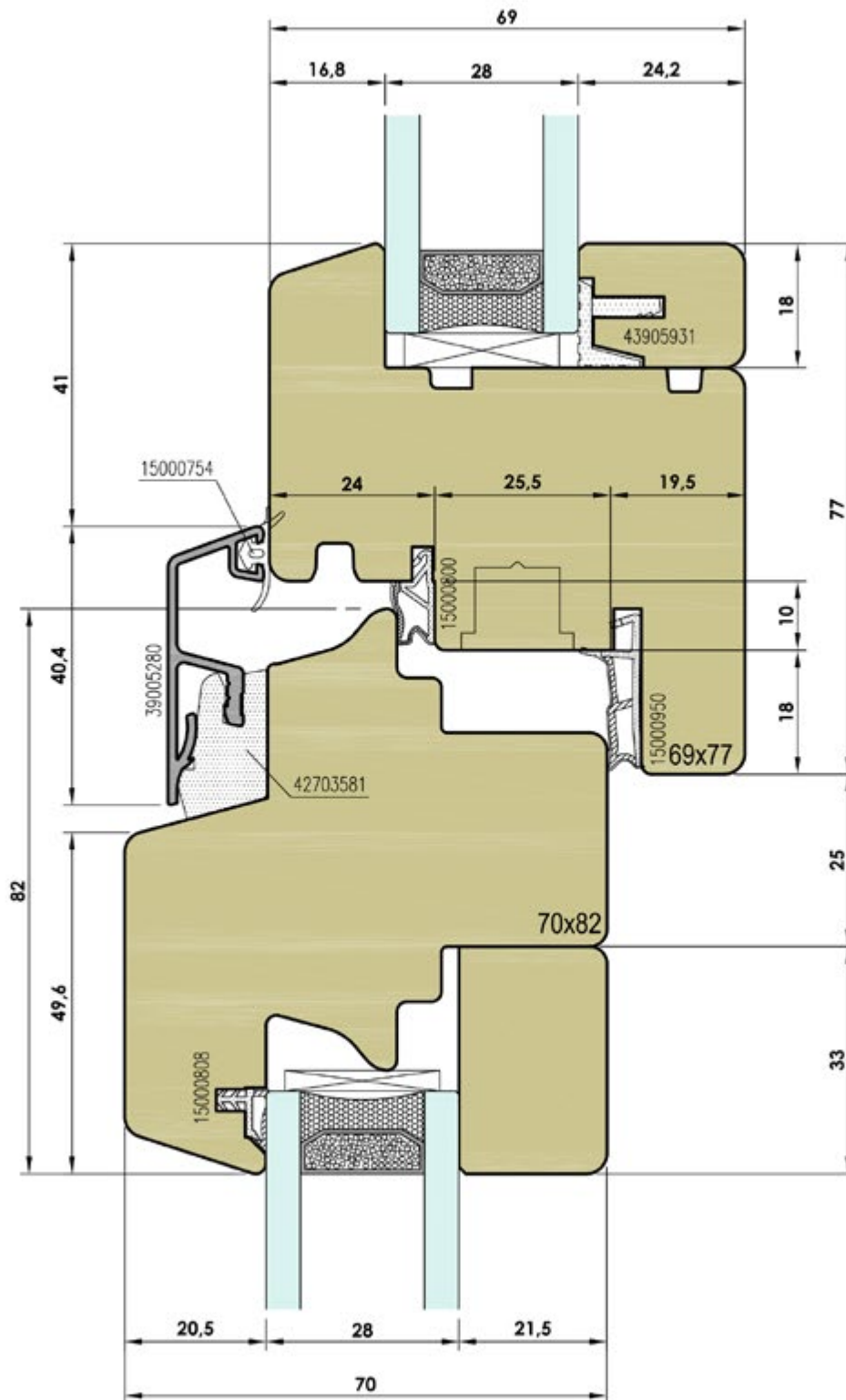
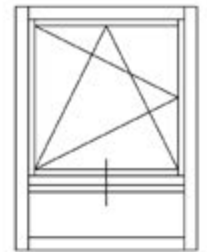

Esperia_69

ESCALA 1:1

- (I) Sezione verticale traverso apribile-fisso
- (F) Section verticale traverse ouvrant-fixe
- (E) Seccion vertical travesaño practicable-fijo
- (UK) Vertical section of the frame's middle ledge

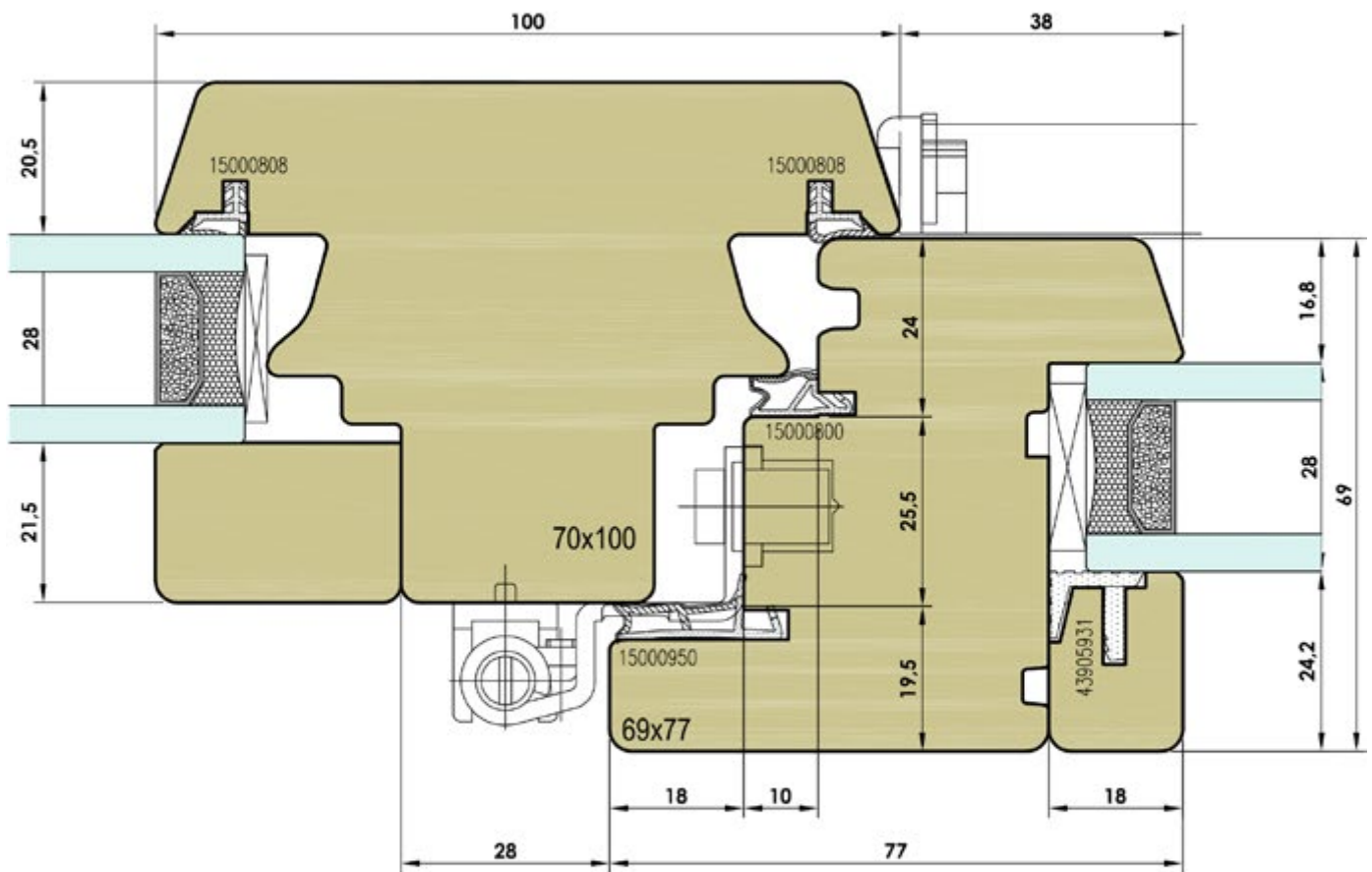
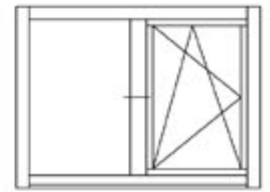

Esperia_69

ESCALA 1:1

- (I) Sezione orizzontale montante apribile-fisso
- (F) Section horizontale montant ouvrant-fixe
- (E) Seccion horizontal montante practicable-fijo
- (UK) Horizontal section of the frame's middle ledger

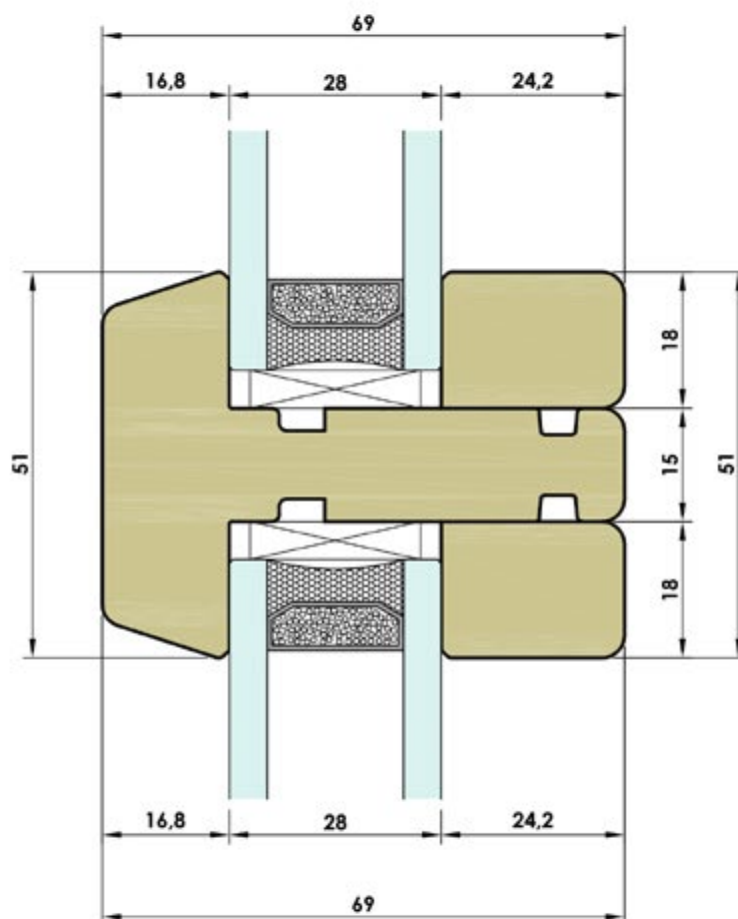
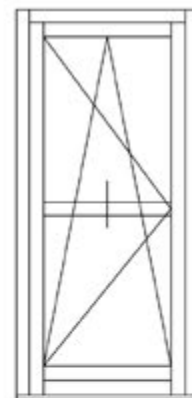

Esperia_69

ESCALA 1:1

- (I) Sezione verticale traverso intermedio anta
- (F) Section verticale traverse intermediaire du vatail
- (E) Seccion vertical travesañõ intermedio hoja
- (UK) Vertical section of the wing middle jamb